



Anker Innovations Limited, All rights reserved. eufy Security and eufy Security Logo are trademarks of Anker Innovations Limited, registered in the United States and other countries. All other trademarks are the property of their respective owners.

51005001739 V02



QUICK START GUIDE

EUFYCAM 2
WIRE-FREE HD SECURITY CAMERA SET

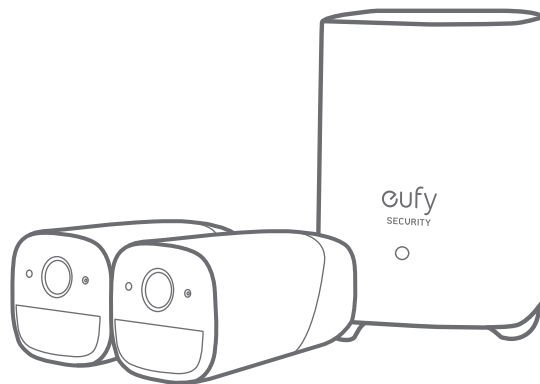

TABLE OF CONTENTS

What's Included **01**

Product Overview **02**

Connecting the HomeBase 2 **03**

Setting Up the System **04**

05 Mounting the Camera

10 Charging eufyCam 2

11 Safety Statement

WHAT'S INCLUDED

For HomeBase 2 installation



HomeBase 2
(T8010)



Power Adapter
for HomeBase 2



Ethernet
Cable



Metal Pin
for Resetting

For eufyCam 2 installation



eufyCam 2
(T8114)



Micro-USB
Charging Cable



Mounting
Bracket



Mounting Screws
and Anchors



Indoor Mount



Hook
(for Indoor Mount)

1. Camera quantity and accessories vary by bundle package.
2. HomeBase 2 power adapter varies by region.

2 / PRODUCT OVERVIEW

HomeBase 2

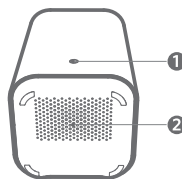

1. Status LED
2. Speaker
3. Power port
4. USB port

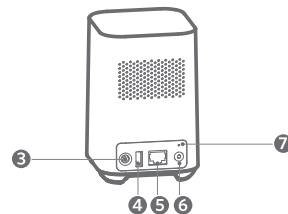

5. Ethernet port
6. SYNC/ALARM OFF button
7. Reset button

eufyCam 2

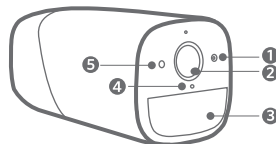

1. Photosensitive sensor
2. Camera lens
3. Motion sensor
4. Microphone

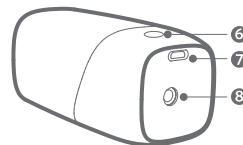

5. LED indicator
6. Sync button
7. USB charging port
8. Screw hole

3/ CONNECTING THE HOMEBASE 2

Connect the HomeBase 2 to the Internet

1. Power on the HomeBase 2, then use the ethernet cable provided to connect the HomeBase 2 to your home router.

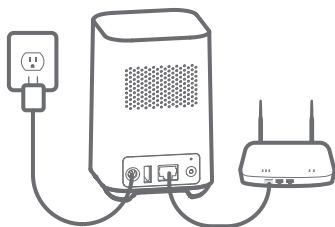

2. The LED indicator turns blue (this may take up to 1min) when HomeBase 2 is ready for setup.

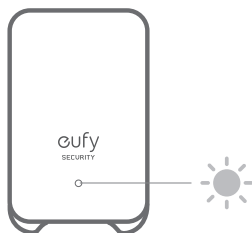

4/ SETTING UP THE SYSTEM

Download the App and Set up the System

Download the Eufy Security app from the App Store (iOS devices) or Google Play (Android devices).



Sign up for a Eufy Security account, then follow the onscreen instructions to complete the setup.

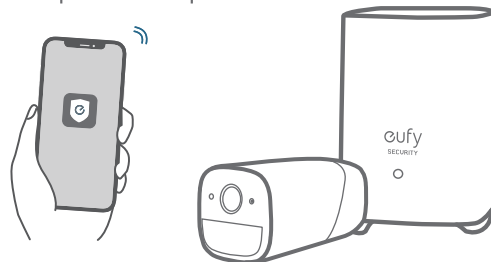

Note:

- Keep the camera at least 1 ft away from your internal / external hard drives.
- Make sure you place the camera near HomeBase 2 (within the distance of 1 ~ 3 feet).
- Make sure you set up HomeBase 2 and eufyCam 2 on the App before you mount the cameras.

5 / MOUNTING THE CAMERA

Find a Good Mounting Spot

To find a spot to mount eufyCam 2, you need to test wireless signal strength.

- ① Open the Eufy Security app, go to Camera Settings > Mounting Guide.
- ② To test the wireless signal strength, take your camera and phone to the location where you want to mount the camera.
- ③ Move the camera as close to the HomeBase 2 as possible if the wireless signal strength is poor.

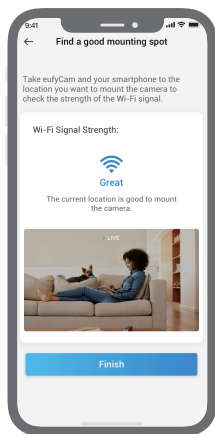

Select Height and Location

Hang eufyCam 2 7-10 ft (2-3 m) above the ground. This height maximizes the detection range of the motion sensor of eufyCam 2. Avoid placing eufyCam 2 under direct sunlight.

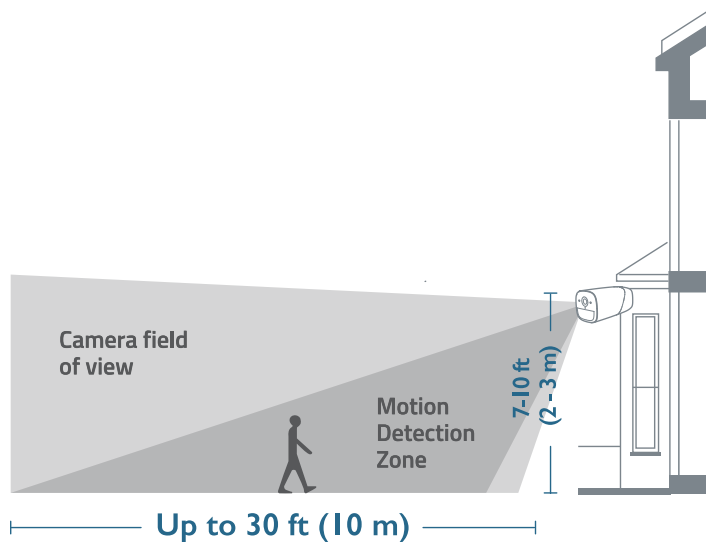

Mount the camera outdoors

The camera can be mounted both indoors and outdoors.

1. Turn the knob of the mounting bracket clockwise to loosen and disassemble it.

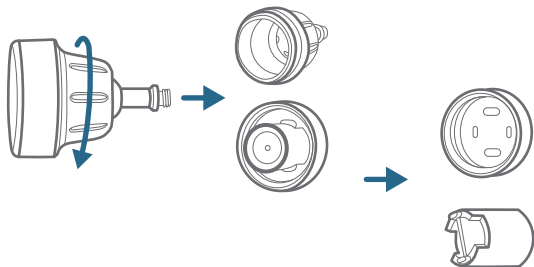

2. Drill holes with a 15/64 inch (5.95mm) drill bit, then insert the anchors into the holes; anchors are necessary for walls that are made out of hard materials such as concrete, brick, or stucco.

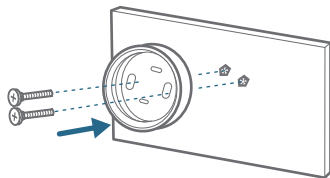

Mount the camera outdoors

3. Firmly screw the base of the mounting bracket onto the wall. Fasten the ball knob of the bracket to the base of the bracket.

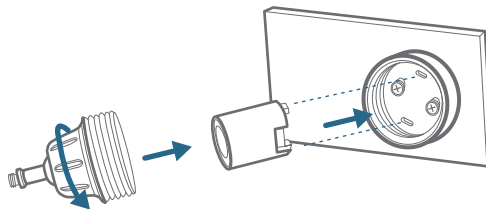

4. Tighten eufyCam 2 to the mounting bracket and adjust the viewing angle by checking the live stream feed in the Eufy Security app.

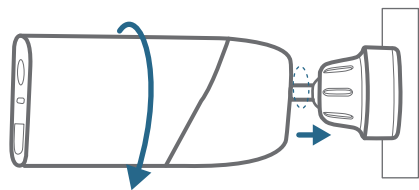

Tips:

1. The Homebase 2 pairs up to 16 cameras, you can repeat the steps mentioned above to add more eufyCam 2 cameras to meet different needs of use.
2. For troubleshooting, check Help on the Eufy Security App. Refer to App page for LED indicator status.

Mount the Camera Indoors

Stick the camera directly to any flat surface made out of iron. Or you can use the indoor mount to mount the camera:

1. Drill a hole. Use the included anchor if it's drywall and fasten the hook.

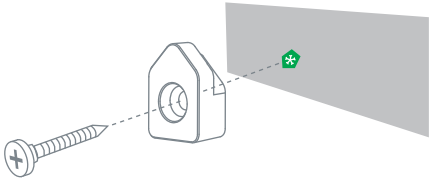

2. Hang the indoor mount on the hook.

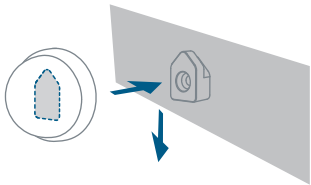

3. Attach eufyCam 2 to the indoor mount and adjust the viewing angle.

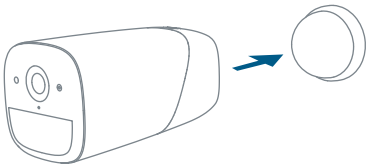

6 / CHARGING EUFYCAM 2

Charge eufyCam 2

Method 1

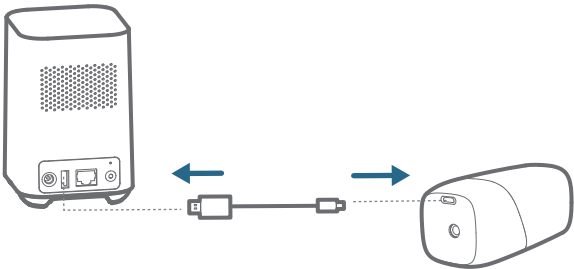

Method 2

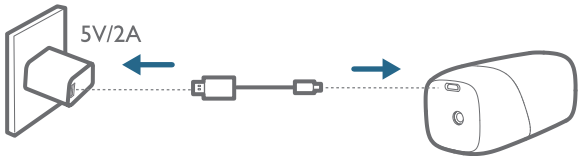

LED indication	Charging: Steady blue
	Fully charged: Off
Charging time	12 hours

7 / SATETY STATEMENT

FCC Statement

This device complies with Part 15 of the FCC Rules. Operation is subject to the following two conditions: (1) this device may not cause harmful interference, and (2) this device must accept any interference received, including interference that may cause undesired operation.

Warning: Changes or modifications not expressly approved by the party responsible for compliance could void the user's authority to operate the equipment.

Note: This equipment has been tested and found to comply with the limits for a Class B digital device, pursuant to Part 15 of the FCC Rules. These limits are designed to provide reasonable protection against harmful interference in a residential installation.

This equipment generates uses and can radiate radio frequency energy and, if not installed and used in accordance with the instructions, may cause harmful interference to radio communications. However, there is no guarantee that interference will not occur in a particular installation. If this equipment does cause harmful interference to radio or television reception, which can be determined by turning the equipment off and on, the user is encouraged to try to correct the interference by one or more of the following measures: (1) Reorient or relocate the receiving antenna. (2) Increase the separation between the equipment and receiver. (3) Connect the equipment into an outlet on a circuit different from that to which the receiver is connected. (4) Consult the

dealer or an experienced radio/TV technician for help.

FCC Radio Frequency Exposure Statement

The device has been evaluated to meet general RF exposure requirements. The device can be used in fixed/mobile exposure condition. The min separation distance is 20cm.

Notice: Shielded cables

All connections to other computing devices must be made using shielded cables to maintain compliance with FCC regulations.

The following importer is the responsible party
Company Name: Fantasia Trading LLC
Address: 9155 Archibald Avenue, Suite 202,
Rancho Cucamonga, CA 91730, USA
Telephone: 1-909-484-1530

CE This product complies with the radio interference requirements of the European Community.

Declaration of Conformity

Hereby, Anker Innovations Limited declares that this device is in compliance with the essential requirements and other relevant provisions of Directive 2014/53/EU. For the declaration of conformity, visit the Web site www.eufylife.com. Due to the used enclosure material, the product shall only be connected to a USB Interface of version 2.0 or higher. The adapter shall be installed near the equipment and shall be easily accessible. Do not use the Device in the environment at too high or too low temperature, never expose

the Device under strong sunshine or too wet environment.
The suitable temperature for HomeBase 2 and accessories is -10°C-45°C.
The suitable temperature for eufyCam 2 and accessories is -20°C-50°C.
When charging, please place the device in an environment that has a normal room temperature and good ventilation.

It is recommended to charge the device in an environment with a temperature that ranges from 5°C~25°C.
Please ensure to use only the charger offered by the manufacturer. Using unauthorized charger may cause danger and violate the authorization of the device and the guarantee article.

This charger is for indoor use only
The charger type is ASSA67W-120200, output voltage/current is 12Vdc/2A. The plug considered as disconnect device of adapter. RF exposure information: The Maximum Permissible Exposure (MPE) level has been calculated based on a distance of d=20 cm between the device and the human body. To maintain compliance with RF exposure requirement, use product that maintain a 20cm distance between the device and human body.

CAUTION RISK OF EXPLOSION IF BATTERY IS REPLACED BY AN INCORRECT TYPE. DISPOSE OF USED BATTERIES ACCORDING TO THE INSTRUCTIONS.

Wi-Fi Operating Frequency

Range: 2412~2472MHz ; Wi-Fi Max Output Power: 19dBm
SUB-1G Frequency range: 866~866.8MHz;
SUB-1G Output Power: 12.4dBm

The following importer is the responsible party (contact for EU matters only)
Importer: Anker Technology (UK) Ltd
Importer Address: Suite B, Fairgate House, 205 Kings Road, Tulseley, Birmingham, B11 2AA, United Kingdom



This product is designed and manufactured with high quality materials and components, which can be recycled and reused.



This symbol means the product must not be discarded as household waste, and should be delivered to an appropriate collection facility for recycling. Proper disposal and recycling helps protect natural resources, human health and the environment. For more information on disposal and recycling of this product, contact your local municipality, disposal service, or the shop where you bought this product.

IC Statement

This device complies with Industry Canada licence-exempt RSS standard(s). Operation is subject to the following two conditions:

(1) this device may not cause interference, and
(2) this device must accept any interference, including interference that may cause undesired operation of the device."

Le présent appareil est conforme aux CNR d'Industrie Canada applicables aux appareils radio exempts de licence. L'exploitation est autorisée aux deux conditions suivantes:

(1) l'appareil n'émet pas de brouillage, et
(2) l'utilisateur de l'appareil doit accepter tout brouillage radioélectrique subi, même si le brouillage est susceptible d'en compromettre le fonctionnement."

This Class B digital apparatus complies with Canadian ICES-003.

Cet appareil numérique de la classe B est conforme à la norme NMB-003 du Canada.

IC RF Statement:

When using the product, maintain a distance of 20cm from the body to ensure compliance with RF exposure requirements.

Lors de l'utilisation du produit, maintenez une distance de 20 cm du corps afin de vous conformer aux exigences en matière d'exposition RF.

Customer Service

Warranty

12-month limited warranty

Call Us

United States	+1 (800) 988 7973	Mon-Fri 9am-5pm (PT)
United Kingdom	+44 (0) 1604 936 200	Mon-Fri 6am-11am (GMT)
Germany	+49 (0) 69 9579 7960	Mo-Fr 6:00-11:00

Email Us

Customer Support: support@eufylife.com

Anker Innovations Limited

Room 1318-19, Hollywood Plaza, 610 Nathan Road, Mongkok, Kowloon, Hong Kong



@EufyOfficial



@EufyOfficial



@EufyOfficial

